

ActivPanel[®]

Titanium[™] with USB-C



DISPLAY

| | |
|----------------------|---|
| Diagonal Size | 70" 4K, 75" 4K, 86" 4K |
| Screen Type | TFT LCD (Direct LED Backlight) |
| Aspect Ratio | 16:9 |
| Display Area | 70" 4K: 1541 x 868 mm (60.7 x 34.2 in) 75" 4K: 1652 x 930 mm (65 x 36.6 in) 86" 4K: 1895 x 1066 mm (74.6 x 41.9 in) |
| Display Colors | 1.07 Billion |
| Resolution | 4K UHD (3840 x 2160 @ 60 Hz) |
| Response Time | 8 ms |
| Panel Refresh Rate | 60 Hz |
| LED Lifespan | 50,000 hours |
| LCD Viewing Angle | 178° |
| Brightness | 70" 4K: 370 cd/m2 75" 4K: 370 cd/m2 86" 4K: 400 cd/m2 |
| Contrast Ratio | 4000:1 |
| Ambient Light Sensor | Yes |
| Glass Hardness | 9H (Pencil), 7 (Mohs) |
| Glass Type | Heat-tempered, Anti-Glare |

INTERACTIVITY

| | |
|--------------------------------|--|
| Angled Center Console | Yes, with Power, Volume Control, Menu, Freeze, No Touch, Source Selection Buttons |
| Touch Technology | Vellum [™] Writing Technology |
| Continuous Touch Points | 20 |
| Touch Resolution | 32768 x 32768 px |
| Response Time | ≤5 ms |
| Touch Accuracy | 1 mm |
| Tracking Rate | 6 m/s |
| Scan Rate | 200 Hz |
| Gestures and Edge Swipes | Windows [®] Supported |
| Eraser Included (Block Eraser) | 1 |
| Pens Included | 4 with Rear Erasing Feature |
| Pen Type | Battery-less Pen |
| Pen Holder | Integrated Full-length Pen Tray |
| Pen Tip Diameter | 3 mm |
| Pen and Touch Differentiation | Yes |
| Pen Identities | 2 |
| Palm Detection | Yes |
| Annotation Over Any Source | Yes |
| Classroom Essential Apps | Including Whiteboard, Annotate, Timer, Spinner, Screen Capture, Screen Share, Browser, PDF Reader, Media Players |
| Compatibility | Windows [®] 8 to 10; OS X [®] 10.8 to 10.11 macOS [®] Sierra 10.12.1 or later; Linux [®] Ubuntu [®] 18.04 LTS; Chrome OS [™] |

CONNECTIVITY

| | |
|--|---------------------|
| HDMI [®] 2.0 In (Rear) | 1 |
| HDMI 2.0 In (Front) | 1 |
| HDMI 2.0 Out | 1 |
| Display Port 1.2 In | 1 |
| VGA In | 1 |
| VGA Audio In | 1 |
| USB-A 2.0 (Rear) | 2 |
| USB-A 3.0 (faster data transfer, Rear) | 1 |
| USB-A 3.0 (faster data transfer, Front) | 2 |
| USB-B Touch (Rear) | 2 |
| USB-B Touch (Front) | 1 |
| USB-C (PD3.0/ USB3.0 inc Touch/ DP1.2, Rear) | 1 |
| LAN In (RJ45) | 1x 10/100/1000 Mbps |
| LAN Out (RJ45) | 1x 10/100/1000 Mbps |
| Wake-on-LAN | Yes |
| Wi-Fi [®] Module IEEE [®] 802.11a/b/g/n/ac | Included |
| Wireless, 2x2 | |
| Bluetooth [®] 4.2 | Yes |
| RS-232 | Yes |
| CVBS | 1 |
| Mic In (3.5 mm) | 1 |
| Headphone | 1 |
| Proximity Sensor for Warm Boot | Yes |
| OPS Slot | 1 |

COMPUTING

| | |
|-----------------------------|--|
| Operating System | Android [™] Oreo 8 |
| RAM | 4 GB |
| Internal Storage | 64 GB (32 GB x2) |
| CPU | Quad Core: (2) ARM Cortex A73, (2) ARM Cortex A53 |
| GPU | ARM Mali-G51 MP4 |
| Remote Over-the-Air Updates | Yes |
| Promethean Panel Management | Yes |

AUDIO

| | |
|---|--|
| Dual Front Facing, Bass Enhanced Speakers | 70" 4K: 2 x15 Watts 75" 4K: 2 x15 Watts 86" 4K: 2 x 20 Watts |
|---|--|

ActivPanel[®]

Titanium[™] with USB-C

POWER

| | |
|-----------------------------|--|
| Power Requirements | 100V - 240V AC |
| Power Consumption (Typical) | 70" 4K: 115W 75" 4K: 124W 86" 4K: 195W |
| Power Consumption (Standby) | <=0.5 W |
| Ultra-Quiet Fanless Design | Yes |

ENVIRONMENTAL

| | |
|-----------------------|------------------------------------|
| Operating Temperature | 0°C to 40°C (32°F to 104°F) |
| Storage Temperature | -15°C to 55°C (-5°F to 131°F) |
| Operating Humidity | 20% to 80% non-condensing humidity |
| Storage Humidity | 20% to 90% non-condensing humidity |

PHYSICAL SPECIFICATIONS

| | |
|-----------------------|--|
| Panel Dimensions | 70" 4K: 1668 x 1033 x 95 mm (65.7 x 40.7 x 3.7 in) 75" 4K: 1764 x 1089 x 109 mm (69.4 x 42.9 x 4.3in) 86" 4K: 2014 x 1231 x 109 mm (79.3 x 48.5 x 4.3 in) |
| Packed Dimensions | 70" 4K: 1796 x 1145 x 278 mm (70.7 x 45.1 x 11.0 in) 75" 4K: 1895 x 1200 x 278 mm (74.6 x 47.2 x 11.0in) 86" 4K: 2140 x 1350 x 278 mm (84.3 x 53.1 x 11.0in) |
| Net Weight | 70" 4K: 53 kg (117 lbs) 75" 4K: 60 kg (132 lbs) 86" 4K: 75 kg (165 lbs) |
| Packed Weight | 70" 4K: 75.5 kg (166.4 lbs) 75" 4K: 85.5 kg (188.5 lbs) 86" 4K: 101.6 kg (224.0 lbs) |
| Wall Mount Dimensions | 1010 x 720 x 52 mm (39.8 x 28.3 x 2.0 in) |
| VESA Mount Point | 70" 4K: 600 x 400 mm (23.6 x 15.7 in) 75" 4K: 800 x 400 mm (31.5 x 15.7 in) 86" 4K: 800 x 400 mm (31.5 x 15.7 in) |

COMPLIANCE & CERTIFICATION

| | |
|---------------------------|---|
| Regulatory Certifications | CE, FCC, IC, UL, CUL, CB, RCM |
| Energy Star Certified | 70" 4K: Yes 75" 4K: Yes 86" 4K: Yes |

EDUCATION SOFTWARE LICENSE

| | |
|--|----------|
| ActivInspire [®] Professional | Included |
| Single User | |

PACKED CONTENTS

| | |
|-------------------|---|
| What's in the Box | (1) ActivPanel Titanium (1) 3M Length HDMI Cable (1) 3M Length USB Cable (A-B) (1) 3M Regional Power Cable (1) 2M Length USB-C Cable (1) Remote Control (2) Batteries for Remote Control (4) ActivPanel Titanium Pens (1) Block Eraser (1) Sealed Antistatic Bag (4) VESA mount screws (M6) (1) Mini PC Bracket with screws (1) Quick Install Guide (1) Promethean Wi-Fi/Bluetooth Module (Ti) (2) Antenna (1) Promethean Wi-Fi/Bluetooth Module (Ti) User Guide (1) Wall Mount |
|-------------------|---|

INSTALLATION

The installation of this product should be completed by a qualified installer. Use of components not supplied by Promethean or not meeting minimum specifications may impact performance, safety and warranty. For more information, visit Support.PrometheanWorld.com.

WARRANTY

Warranty term and upgrade options vary by region. Contact your local reseller or distributor for information and visit PrometheanWorld.com/Warranty.

SUPPORT

For all Promethean products, visit Support.PrometheanWorld.com.

ActivPanel[®]

Titanium with USB-C

TECHNICAL DRAWINGS

70"

Front

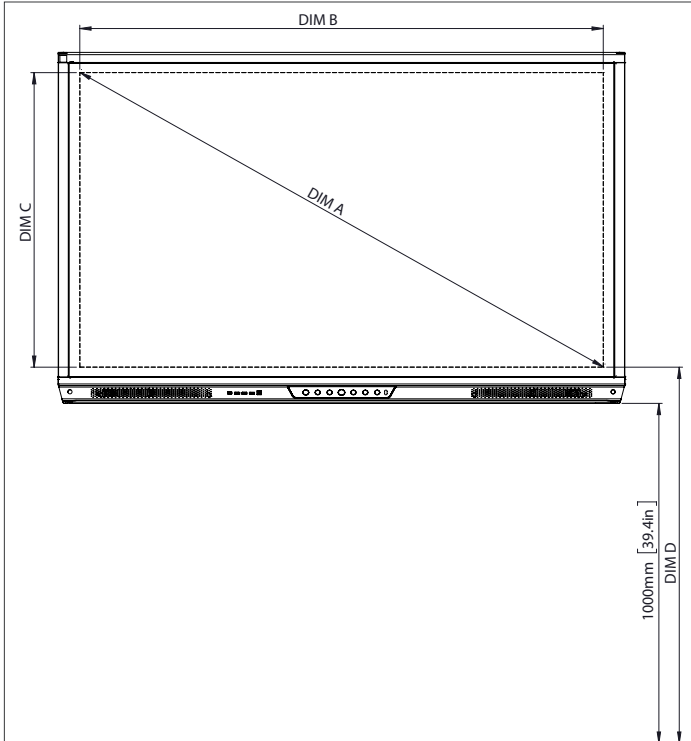

| DIM | DIMENSIONS (MM) | DIMENSIONS (IN) |
|-------|-----------------|-----------------|
| A | 1768 | 70.0 |
| B | 1541 | 60.7 |
| C | 867 | 34.1 |
| D | 1107 | 43.6 |
| E | 136 | 5.4 |
| F | 67 | 2.6 |
| G | 1033 | 40.7 |
| H | 1668 | 65.7 |
| I | 600 | 23.6 |
| J Min | 157 | 6.2 |
| J Max | 295 | 11.6 |
| K Min | 1157 | 45.6 |
| K Max | 1295 | 51.0 |
| L | 95 | 3.7 |

Back

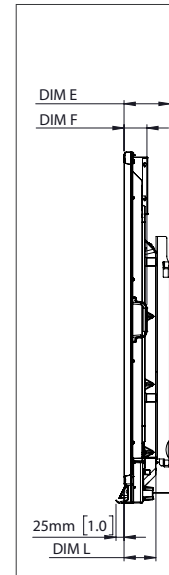
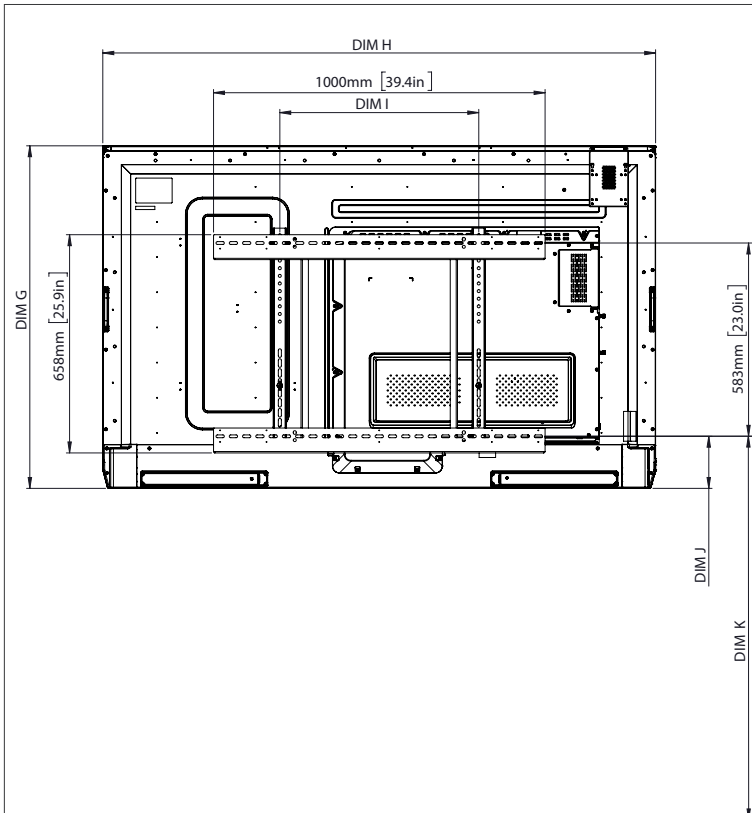

Side

ActivPanel[®]

Titanium with USB-C

TECHNICAL DRAWINGS

75"

Front

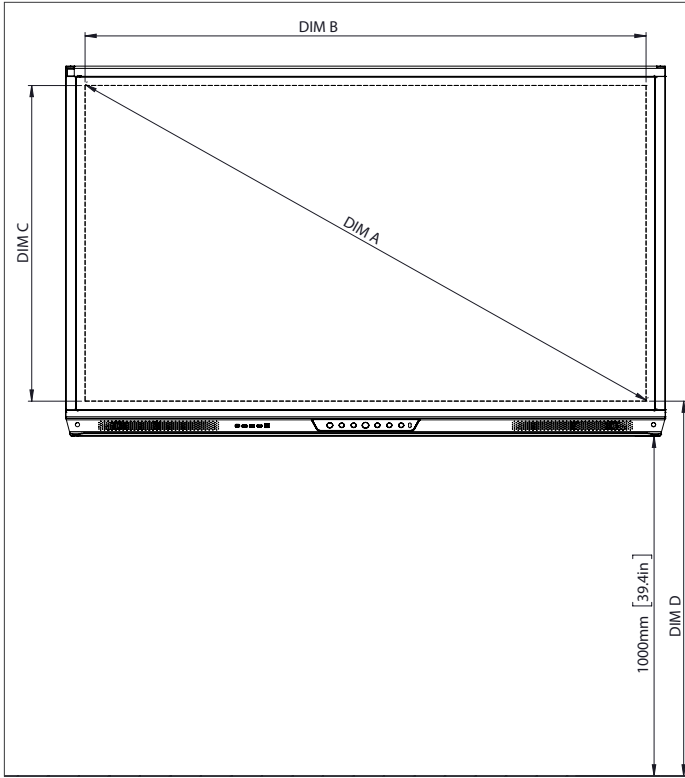

| DIM | DIMENSIONS (MM) | DIMENSIONS (IN) |
|-------|-----------------|-----------------|
| A | 1894 | 75.6 |
| B | 1651 | 65.0 |
| C | 928 | 36.5 |
| D | 1103 | 43.4 |
| E | 133 | 5.2 |
| F | 67 | 2.6 |
| G | 1089 | 42.9 |
| H | 1764 | 69.4 |
| I | 800 | 31.5 |
| J Min | 214 | 8.4 |
| J Max | 352 | 13.9 |
| K Min | 1215 | 47.8 |
| K Max | 1353 | 53.3 |
| L | 109 | 4.3 |

Back

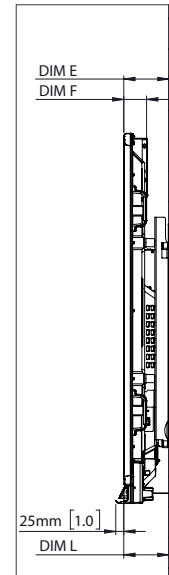
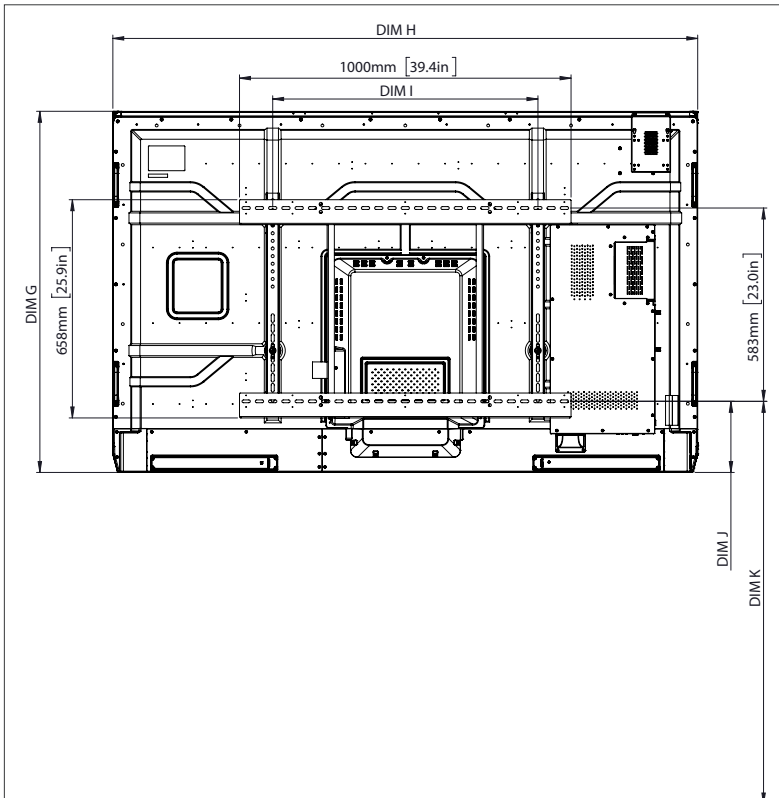

Side

ActivPanel[®]

Titanium with USB-C

TECHNICAL DRAWINGS

86"

Front

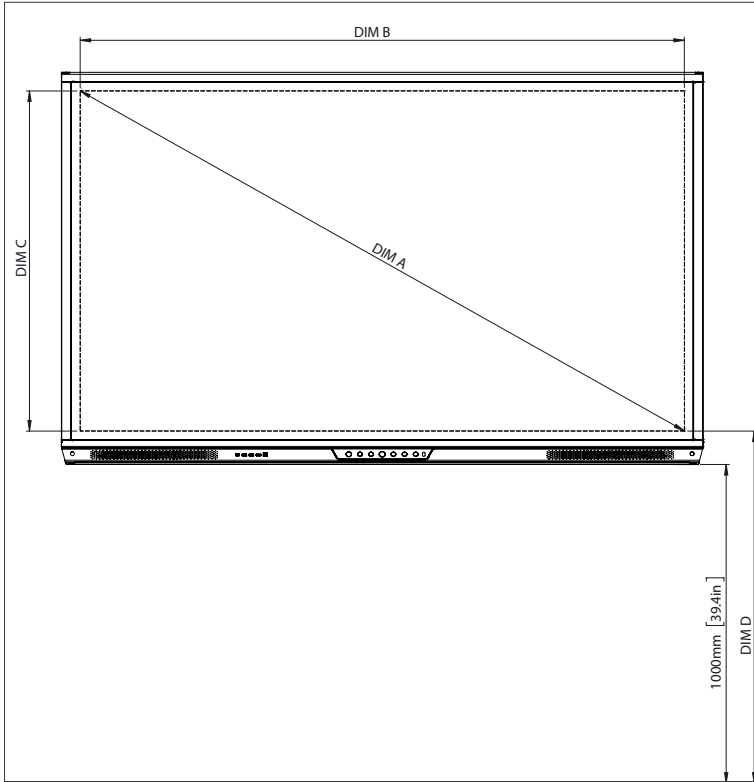

| DIM | DIMENSIONS (MM) | DIMENSIONS (IN) |
|-------|-----------------|-----------------|
| A | 2176 | 85.6 |
| B | 1896 | 74.7 |
| C | 1067 | 42.0 |
| D | 1107 | 43.6 |
| E | 134 | 5.3 |
| F | 67 | 2.6 |
| G | 1231 | 48.5 |
| H | 2014 | 79.3 |
| I | 800 | 31.5 |
| J Min | 286 | 11.3 |
| J Max | 424 | 16.7 |
| K Min | 1286 | 50.6 |
| K Max | 1424 | 56.1 |
| L | 109 | 4.3 |

Back

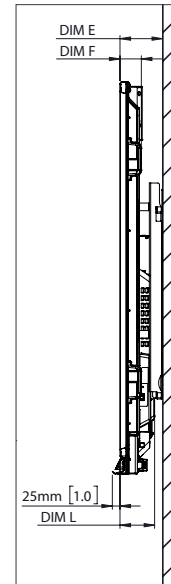
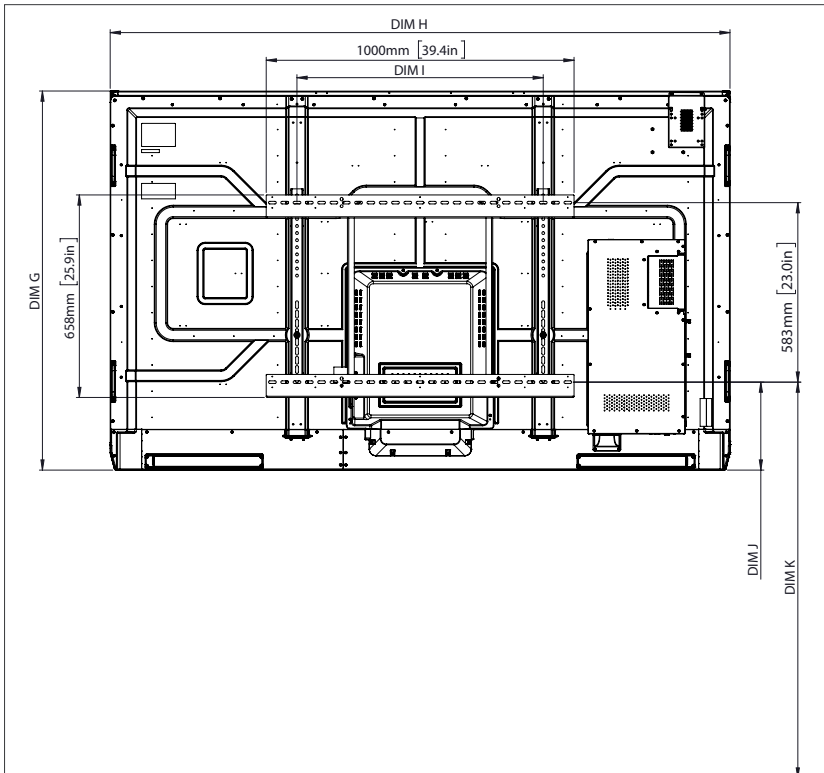

Side